

The background of the cover features large, flowing, wavy lines in shades of yellow and green, creating a sense of movement and freshness.

CLEAN AIR FOR U

CAFU

Product Catalog

## Certificate Highlights



## Certificate Issued by



## Brand Story

CLEAN AIR FOR U

**CAFU** CAFU is...  
short for Clean Air For youU.

# Φ80 ARM HOOD

Arm Hood, attached to the ceiling of laboratory, research room or processing room can effectively discharge the source of contamination Product spec. change is possible according to user's needs with our custom-made production method.



Patent Registration  
NO. 10-1711148

Additional Purchase

OR

ARM HOOD for Round for insertion  
CARBON FILTER

Φ200 Dome  
Available

## Product Spec.

Model Name	Model Name (Filter mounting)	Spec.(mm)
CWAH-80-15	CWAH-C-80-15	Φ80 X 1500
CWAH-80-18	CWAH-C-80-18	Φ80 X 1800
CWAH-80-21	CWAH-C-80-21	Φ80 X 2100
CWAH-80-24	CWAH-C-80-24	Φ80 X 2400
Material	PP(polypropylene)	
Bracket Material	SS41 (Powder Coating Treated)	

## Basic Bracket Type

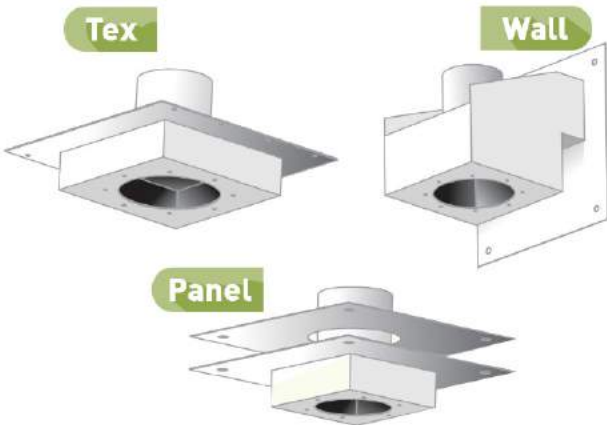





## Custom-Made Bracket

Installation is made easy and fast with custom-made bracket according to the site condition.

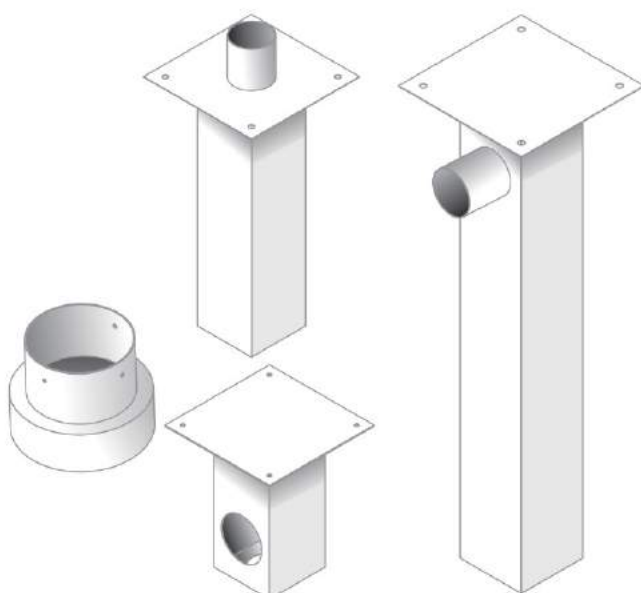

## Installation examples



School



Laboratory

# $\Phi 110$ ARM HOOD

Arm Hood, attached to the ceiling of laboratory, research room or processing room can effectively discharge the source of contamination Product spec. change is possible according to user's needs with our custom-made production method.



## Product Spec.

Model Name	Spec.(mm)
CWAH-110-18	$\Phi 110 \times 1800$
CWAH-110-21	$\Phi 110 \times 2100$
CWAH-110-24	$\Phi 110 \times 2400$
Material	PP(polypropylene)
Bracket Material	SS41 (Powder Coating Treated)

## Basic Bracket Type





Φ110 Pipe Use



Wind Volume  
Controllable Damper



Easy Handling by User with  
360 Degree Rotation



Dome Size Selection  
between Φ450 and Φ250



Easy Disassembly, Assembly  
and Moving with the Use of  
Control Bolt



Sagging From Long Time  
Use Prevented by Gas Spring

## Custom-Made Bracket

Installation is made easy and fast with custom-made bracket according to the site condition.

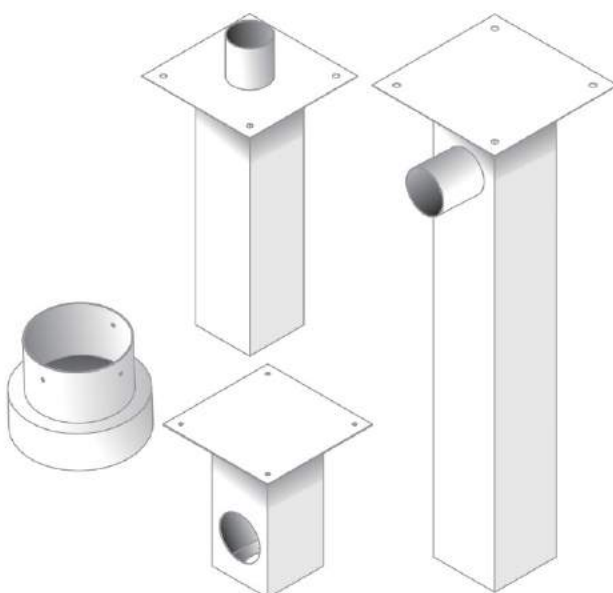

## Installation examples



Industrial Site

# Flexible Hose

Flexible Hose, attached to the ceiling, partially discharges the source of contamination in the laboratory, research room or processing room.  
Easy moving to exhaust needing area without being fixed to installed spot.

Patent Registration  
NO. 10-1535443



## Product Spec.

Model Name	Spec.(mm)
CWMH-12	$\Phi 77 \times 1200$ (34 basis)
Material	POM (Acetal)

## Working Dynamics

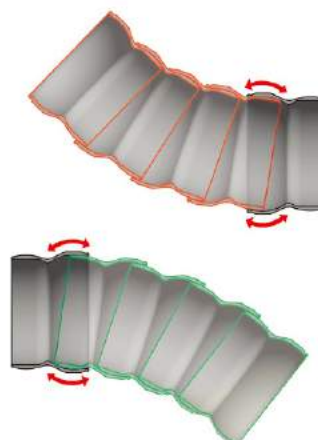



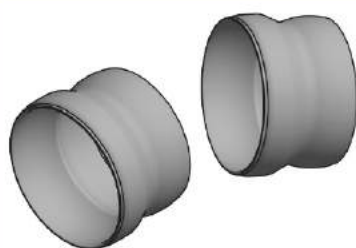

Easy Washing  
after Disassembly

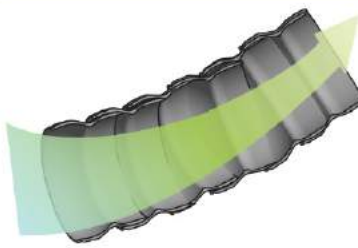

Designed to Minimize  
Air Stagnation

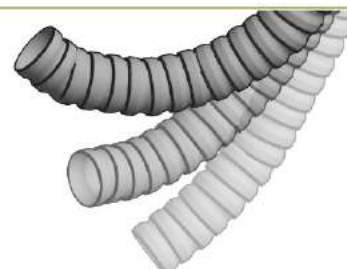

Easy Moving  
with Easy Touch



Φ250, Φ150  
Selectable Dome

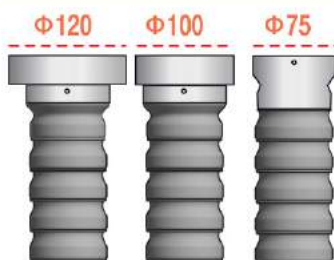

Customized  
Connection Bracket



Resistant against Chemical,  
Heat, Weather and Abrasion

## Size ( mm )

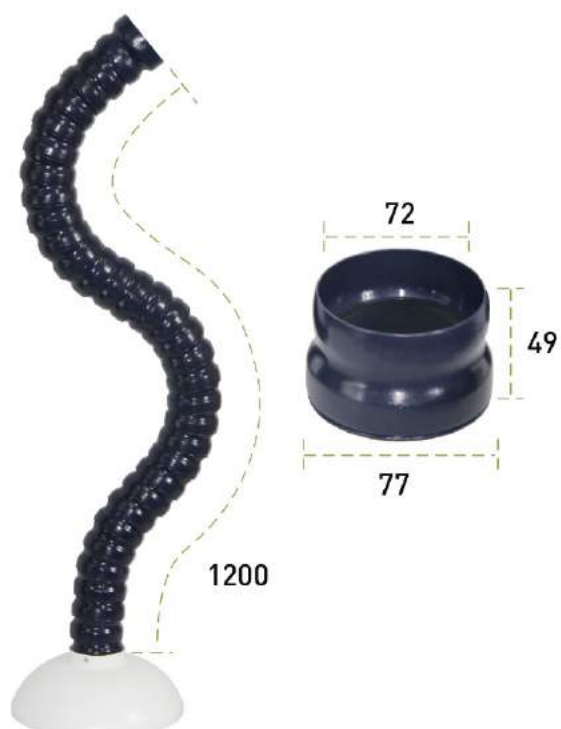

## Installation examples



Industrial Site



Industrial Site



# Table Top Local Exhaust Ventilation Unit

Table Top Local Exhaust Ventilation Unit, by being placed on the table of laboratory, research room and soldering room, effectively discharges the source of contamination. Easy elimination of contamination through a compact size ventilation unit with the use of flexible hose that can free up the space limitation.

Patent Registration  
NO. 10-1535444



## Product Spec.

Model Name	Spec.(mm)
CAFU-01	330 X 330 X 420
Material	Plate 1.2t With Epoxy Powder Coated
Noise Leve	≤55dB
Flow Speed	9m/s
Rated	220V, 50/60Hz, 60W
Weight	17kg

## Size (mm)



Anti-bacterial pre filter

Carbon deodorizing filter + Sterilizing HEPA filter



Purification and Sterilization of Contamination Source. Perfect Filter Combination

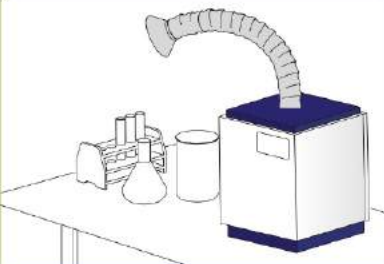

Spacious Table with the Use of Compact Size Ventilator



Easy and Simple Filter Replacement



Filter Replacement Indicator

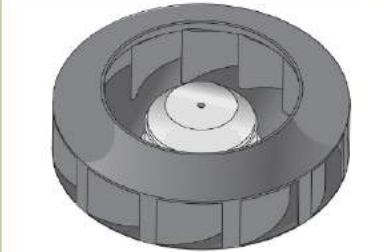

Power Consumption Reduced with BLDC Motor

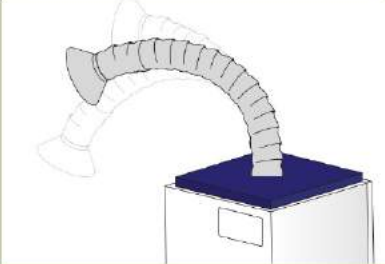

Easy Moving to Desired Spot by Using Flexible Hose

Size (mm)



Additional Purchase

Installation examples



# Portable Local Exhaust Ventilation Unit

Portable local Exhaust Ventilation Unit, by being placed on the table of laboratory, research room or soldering room, effectively discharges the source of contamination. Easy moving to exhaust needing area without being fixed to installed spot.

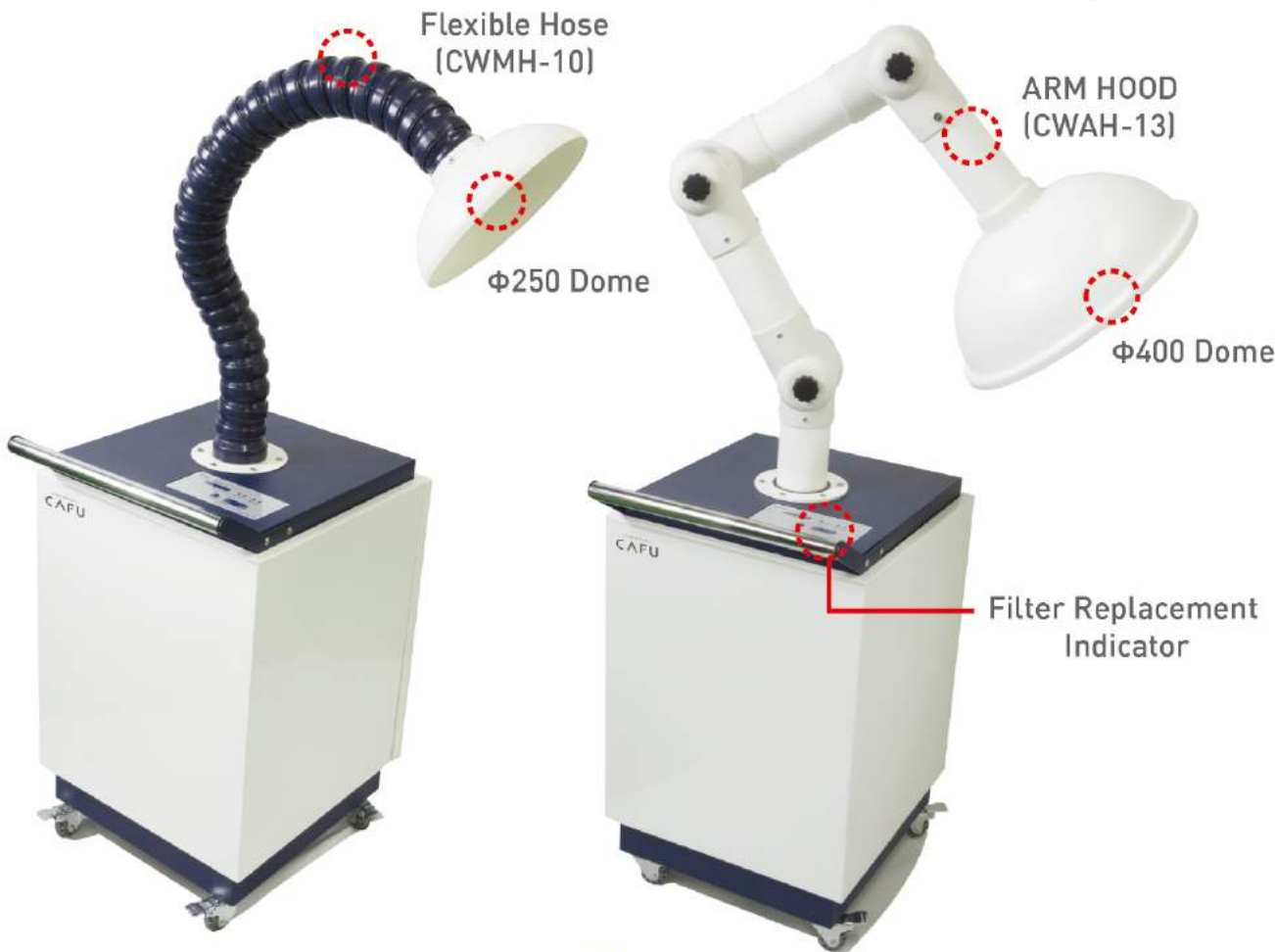

## Product Spec.

Model Name	Spec.(mm)
CAFU-02-10 (Flexible Hose type)	420 X 420 X 705 (Φ77 X 1000)
CAFU-02-13 (ARM HOOD type)	420 X 420 X 705 (Φ80 X 1300)
Material	Plate 1.2t with Epoxy Powder Coated
Noise Level	≤55dB
Flow Speed	9 ~ 11m/s
Rated	220V, 50/60Hz, 120W
Weight	30kg

## Size (mm)





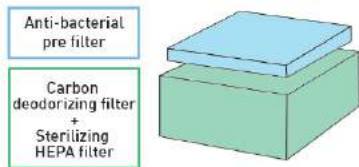

Purification and Sterilization of Contamination Source. Perfect Filter Combination

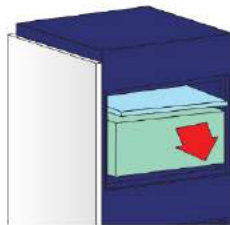

Easy and Simple Filter Replacement



Urethane Bearing Wheel Reduces Noise and Makes Moving Much Easier



Filter Replacement Indicator

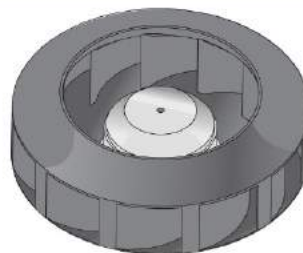

Power Consumption Reduced with BLDC Motor

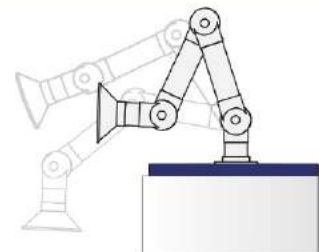

Easy Moving to Desired Spot with Simple Handling

## ARM HOOD(CWAH-13) Dome Selection



Φ400 Dome(PP , PC),  
Φ200 Dome(PP)

## Installation examples



laboratory



Built-in  
local exhaust ventilation

# Table Top Dust Collector

Processing areas of dentist items, parts, metal and grinding are suitable places for using Table Top dust collector to remove small amount of dry particle. Flexible hose attached to main body enables easy and free moving to desired spot.

Patent Registration  
NO.10-1664865



## Product Spec.

Model Name	Spec.(mm)
CWCAFU-03	330 X 540 X 370
Material	Plate 1.6t with Epoxy Powder Coated
Noise Level	≤60dB
Flow Speed	17m/s
Rated	220V, 50/60Hz, 250W
Weight	20kg
Filter Material	Polyester

## Size (mm)

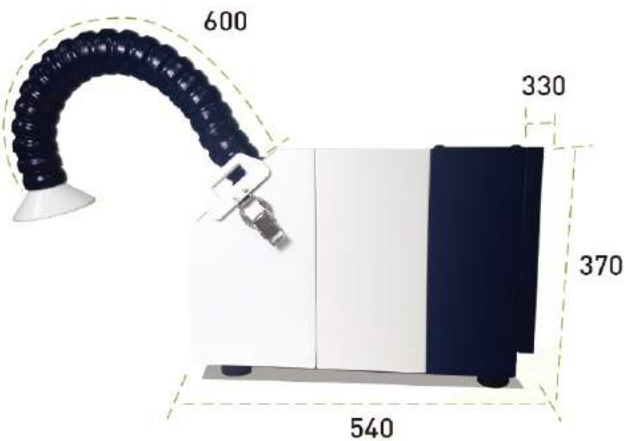

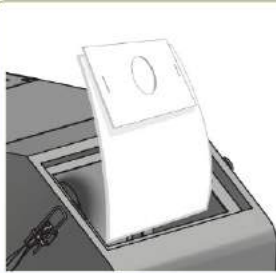

Easy Filter Replacement

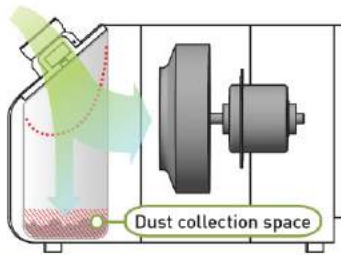

Designed to Minimize Filter Static Pressure

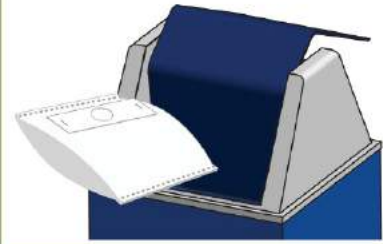

Simple Filter Throw Out to Prevent 2nd Contamination (Disposable)

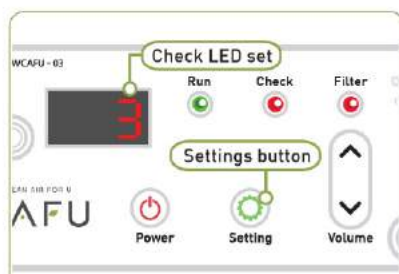

Wind Volume, Filter Replacement Indicator

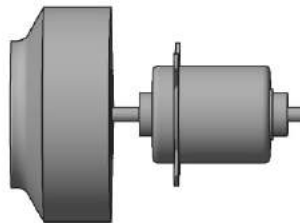

Power Consumption Reduced with BLDC Motor

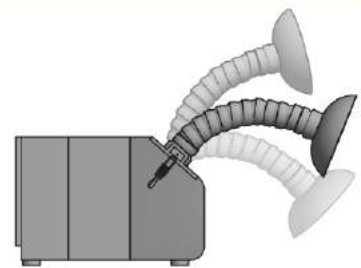

Easy Moving to Desired Spot with Simple Handling

## Structure of Micro Filter

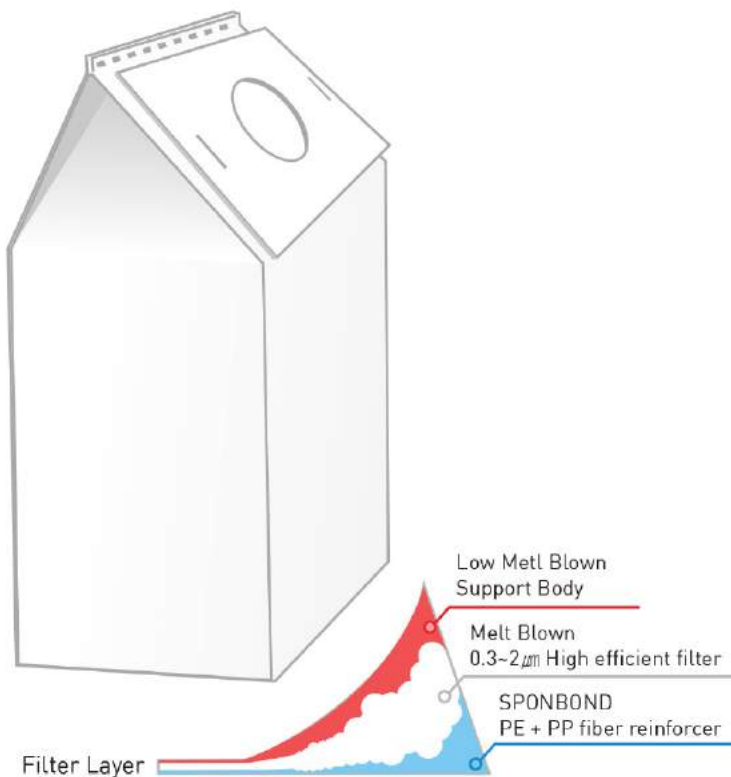

## Installation examples



Industrial Site

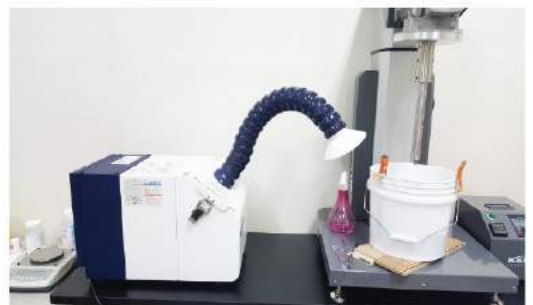

Pharmaceutical company



# Portable Dust Collector

Processing areas of dentist items, parts, metal and grinding are suitable places for using portable dust collector to remove small amount of dry particle. Flexible hose attached to main body enables easy and free moving to desired spot.



Mounting of MicroFilter



## Product Spec.

Model Name	Spec.(mm)
CAFU-04	330 X 450 X 500(mm)
Material	Plate 1.6t with Epoxy Powder Coated
Noise Level	≤60dB
Flow Speed	17m/s
Rated	220V, 50/60Hz, 250W
Weight	25kg
Filter Material	Polyester

## Size (mm)





Easy Filter Replacement



Designed to Minimize  
Filter Static Pressure



Simple Filter Throw  
Out to Prevent  
2nd Contamination (Disposable)



Easy-to-operate rotary button



Power Consumption Reduced  
with BLDC Motor



Urethane Bearing Wheel  
Reduces Noise  
and Makes Moving Much Easier

## Structure of Micro Filter

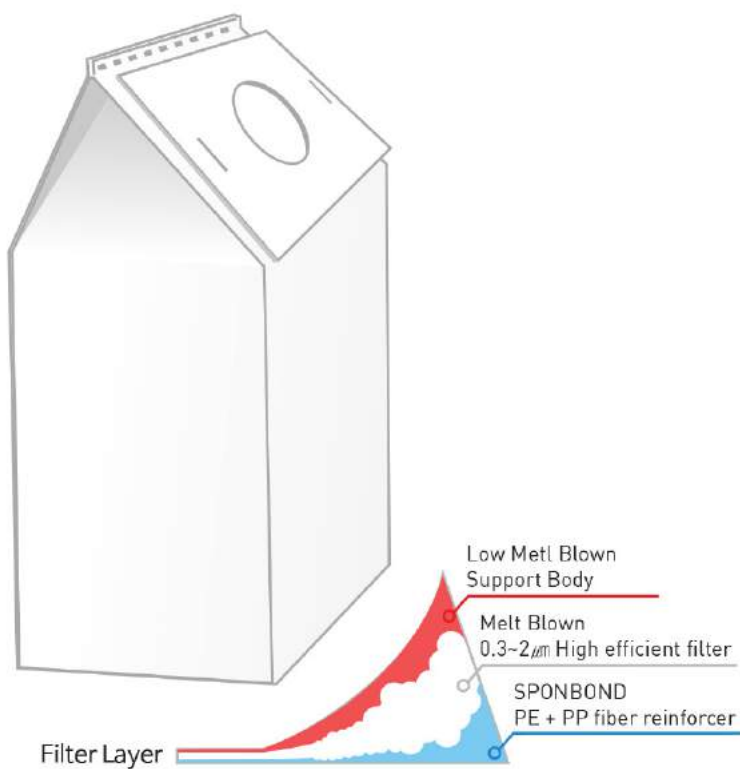

## Installation examples



Pharmacy



Industrial Site

Filter Spec.

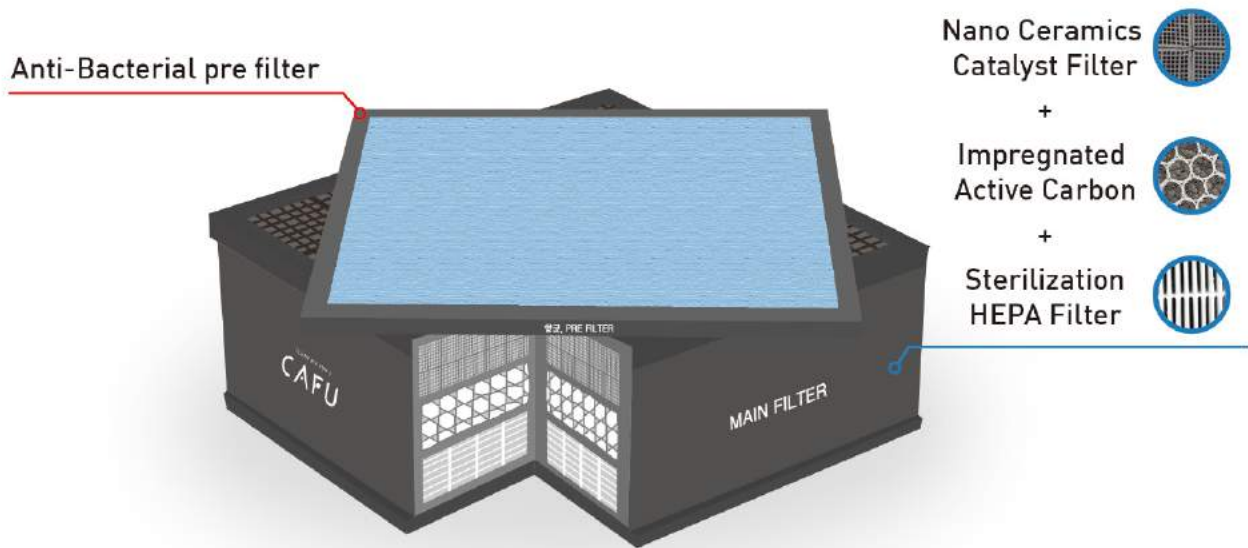

1. Anti-Bacterial Pre Filter

Model Name	CWPF-221	CWPF-331
Treatment Material	Dust at incoming area	
Filter Material	Antibacterial treatment through non-woven fabric	
Replacement Period	150 hour	200 hour
Dimension	220 X 220 X 10T	330 X 330 X 10T

2. Main Filter

Model Name	CHF-2211	CHF-3314
Treatment Material	TVOC (Toluene, Formaldehyde, Ammonia, etc.) + 0.3μm Particle, Sterilization	
Filter Material	Ceramics + Impregnated Active Carbon +Synthetic Fiber + Sterilization	
Replacement Period	300 hour	400 hour
Dimension	220 X 220 X 110T	330 X 330 X 140T

※ The order and replacement cycle of the filter can be changed according to service environment.



# Test Certificate

## 1. Test Certificate of Deodorize Effect of Table Top Local Exhaust Ventilation Unit

Test Category	Unit	Test Method	Test Result	Test Environment
Deodorization Efficiency (Toluene, C <sub>6</sub> H <sub>5</sub> CH <sub>3</sub> )	%	(1)	Over 99.5	( 19 ± 1 )℃ ( 45 ± 5 ) % R. H.
Deodorization Efficiency (Formaldehyde, HCHO)	%	(1)	99	( 19 ± 1 )℃ ( 45 ± 5 ) % R. H.
Deodorization Efficiency (Ammonia, NH <sub>3</sub> )	%	(1)	96	( 19 ± 1 )℃ ( 45 ± 5 ) % R. H.
Deodorization Efficiency (Acetaldehyde, CH <sub>3</sub> CHO)	%	(1)	96	( 19 ± 1 )℃ ( 45 ± 5 ) % R. H.
Deodorization Efficiency (Acetic Acid, CH <sub>3</sub> COOH)	%	(1)	96	( 19 ± 1 )℃ ( 45 ± 5 ) % R. H.
Deodorization Efficiency	%	(1)	97	( 19 ± 1 )℃ ( 45 ± 5 ) % R. H.

[Tested by : Korea Conformity Laboratories]

## 2. Test Certificate of Deodorize Effect of Portable Local Exhaust Ventilation Unit

Test Category	Unit	Test Method	Test Result	Test Environment
Deodorization Efficiency (Toluene, C <sub>6</sub> H <sub>5</sub> CH <sub>3</sub> )	%	(1)	Over 99.5	( 19 ± 1 )℃ ( 45 ± 5 ) % R. H.
Deodorization Efficiency (Formaldehyde, HCHO)	%	(1)	Over 99.5	( 19 ± 1 )℃ ( 45 ± 5 ) % R. H.
Deodorization Efficiency (Ammonia, NH <sub>3</sub> )	%	(1)	99	( 19 ± 1 )℃ ( 45 ± 5 ) % R. H.
Deodorization Efficiency (Acetaldehyde, CH <sub>3</sub> CHO)	%	(1)	99.5	( 19 ± 1 )℃ ( 45 ± 5 ) % R. H.
Deodorization Efficiency (Acetic Acid, CH <sub>3</sub> COOH)	%	(1)	97	( 19 ± 1 )℃ ( 45 ± 5 ) % R. H.
Deodorization Efficiency	%	(1)	99	( 19 ± 1 )℃ ( 45 ± 5 ) % R. H.

[Tested by : Korea Conformity Laboratories]

## 3. Test Certificate of Sterilization HEPA Filter

Test Category		Test Result			Test Method	Test Condition
		Concentration before activation (CFU/m <sup>3</sup> )	Concentration after activation (CFU/m <sup>3</sup> )	Germ Reduction Rate (%)		
Airborne Microbe Reduction Test	Air Purifier with HEPA Filter	1.3 x 10 <sup>4</sup>	< 10	99.9	Suggested by Client	( 22.9 ± 0.1 )℃ ( 50.2 ± 0.2 ) % R. H.

[Tested by : Korea Conformity Laboratories]